

IoT Sensor USB Reader

Safetrust IoT Sensor USB readers revolutionize credential management with their versatile, seamless integration into your existing infrastructure. These innovative devices connect access control with logical access at printers, computers, kiosks, and more. Offering centralized credential management, actionable usage insights, and advanced security features such as secure remote management, Safetrust IoT Sensor USB readers empower you to streamline and fortify your access credentials with ease.



Plug, Play & Protect. Versatile Power, Cloud Connectivity, OTA Control.

Key Features



Bridging Legacy to Mobile Credentials

Easily powered from a PC or internally mounted in a printer.



Multiple Configurations

Choose from Keyboard Wedge, OSDP, Smartcard CCID, or USB Serial Port modes.



Credential Support

Works with DESFire EV1/2/3, iCLASS™, BLE, Apple Access (NFC), Apple Value Added Services (NFC), Android NFC, 125kHz credentials and more.



Connectivity

Supports Wi-Fi 5.8GHz, BLE Mesh for cloud management.



Secure Element

Anchored by an EAL6+ secure element for maximum data protection.



Enhanced Security Features

IoT Sensor USBs are designed with security in mind. They include microelectronics design, secure element inter-processor encryption, memory encryption, tamper detection, and more to ensure the utmost protection for your credentials.



Multi-Channel Reader

Supports multiple frequency credentials including 125kHz ask, psk, fsk, BLE, Zigbee, Thread, 13.56MHz, ISO14443A, 14443B 15693 18000-3.



Customer Owned Key Management

Supports 'Bring Your Own Key' (BYOK), allowing organizations to choose card manufacturers that best suit their needs and budget. Transition seamlessly from legacy to mobile credentials.



Advanced Cryptography

Housing multiple secure micro-processors, the device easily supports both asymmetric and symmetric credentials both now and into the future. Standards include NIST 800-73, PSIA PKOC, x509, and other credentials based on ECC and RSA.



Robust Security

IoT Sensor USBs inherit all the standard security features that have made Safetrust IoT Sensors the gold standard in credential management. Your credentials will be in safe hands with our secure platform.



Tailored Compatibility, Trusted Safety, and Effortless Control

Universal Compatibility

Safetrust IoT Sensor USBs are designed to work seamlessly with various operating systems, making them versatile tools for your credential management needs. Whether you're using Windows, Mac, Linux, or embedded devices, rest assured that our IoT Sensor USBs will integrate effortlessly into your existing infrastructure.

Usage Insights at Your Fingertips

IoT Sensor USBs are online-capable devices that provide you with valuable usage information. Keep track of credential reads and programming activities via the Safetrust portal, enabling you to monitor and optimize your access control system effectively.

Over-the-air Management

- **Centrally Managed Credentials:** Efficiently distribute new key sets and configuration changes, ensuring your deployed IoT Sensor USB devices stay up-to-date and secure.
- **Configure and Manage Sensors:** Administrators can remotely configure and manage IoT Sensor USBs by applying corporate policies over Wi-Fi (eliminating costly onsite visits) or via BLE on the Safetrust mobile app. Configure and manage your IoT Sensor USBs by applying corporate policies over-the-air, thereby reducing management costs.
- **Future-proof:** Using over the air updates, new credential standards can be rolled out over the organization as they are adopted. Stay updated with firmware updates, configuration changes, and event reporting. As new credentials are released and new features are required, an over-the-air update model allows new software to be deployed without visiting each sensor.



Customizable Output

Customers have the flexibility to configure how credential information is relayed to the desktop or printer.

- **USB Keyboard Configuration:** Configure your IoT Sensor USB as a keyboard wedge for easy credential input. It requires no device drivers, ensuring a hassle-free experience on PCs, Macs, and Linux systems.
- **CCID Smartcard Emulation:** In CCID Smartcard Emulation mode, the IoT Sensor USB works seamlessly with existing desktop products, making it compatible with most badging solutions from various vendors.
- **OSDP:** Data relayed through the OSDP (Open Supervised Device Protocol) ensures secure and standardized communication between access control devices and host systems, enhancing system reliability and security.

MIFARE DESFire Ecosystem Integration

IoT Sensor USBs seamlessly integrate through the MIFARE DESFire ecosystem, ensuring compatibility with existing wall-mounted IoT Sensors. Data stored in the IoT Sensor secure element is securely synchronized using Safetrust Credential Manager, allowing smooth operation.

Mounting Option

Available in wallmount format.

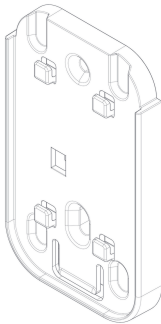

8700-5500-09 - Surface Mount Adapter Bracket

For mounting to wall
(includes screws)

*Accessories sold separately.



IoT Sensor USB

Specifications 1/2

Model Number	SL600
Part Number	All IoT USB Reader part numbers start with 8855. To obtain the complete part number for the product configuration that suits your needs, please consult your Safetrust representative.
Form Factor/Mounting	Desktop (standard) Optional surface mount adapter bracket sold separately.
Input <i>Credential Read Types</i>	Proximity (125kHz), Smart Cards (13.56MHz), Bluetooth Low Energy (2.4 GHz), Near Field Communication (NFC) (13.56MHz)
Output	Wi-Fi, BLE Mesh Network, Emulations supported over USB: Keyboard Wedge, Serial, OSDP, JSON, Smartcard (Q4 2023)
Current Consumption (@5V)	110 mA Average 250mA Peak
Power Supply	5V USB port at 250mA max
Product Weight	94 g / 3.31 oz +/- 5%
Dimensions	3.9 x 7.4 x 2.3 cm (1.57 x 3.05 x .94 in)
Color	Black
Operating Temperature	-35...+65°C / -31...+149°F
Storage Temperature	-35...+85°C / -31...+185°F
Power Consumption	Wi-Fi 2 - 50 mA, BLE 2 - 15 mA
Operating Humidity	5% to 95% relative humidity (non-condensing)
Connection	USB-A and USB-C
Status Indicator	LED and Buzzer
Configuration & Firmware Updates	Wi-Fi (remote via secure cloud portal); BLE (onsite, using administrator's mobile device)
Cable Length	6' (3' available as a special order)
LF Credential Compatibility (125 kHz)	HID®, Indala®, Casi Rusco®, AWID®, Farpointe®, & others <i>*LF compatibility is optional</i>
HF Credential Compatibility (13.56 MHz) <i>(All part numbers)</i>	MIFARE DESFire EV1/2/3, ISO 15693, ISO 14443A/B, CSN/UID, HID® iCLASS secure read, NIST 800-73, FIDO 2, LEAF



IoT Sensor USB

Specifications 2/2

Read Range	High Frequency Java Cards: Up to 4 cm / 1.6"; MIFARE Classic: Up to 6 cm / 2.4"; DESFire EV1/2/3: Up to 6 cm / 2.4"; Low Frequency: Up to 6 cm / 2.8" ; NFC (10 cm / 3.93")
Certifications <i>More pending.</i>	OSDP, IP65, FCC (USA), CE or EN (Europe), IC (Canada), RCN, RoHS2 (TBD), UKCA (Great Britain), India, China, Japan, KC (Korea), Taiwan, NOM & IFTEL (Mexico), Argentina, Saudi Arabia, UAE, Singapore, Phillippeans, Thailand, UL294 *pending)
Mobile Operating Systems and Mobile Devices	BLE: Apple iOS 11.0 or later; Android 4.4 or later on devices with the Safetrust Wallet NFC: Must be running on Apple Access or Android NFC compatible mobile devices.
Mobile Credential	Most popular card formats including Safetrust Mobile BLE, Android, Mobile DESFire Apple Access, mobile FIDO2, and support for other mobile providers with an optional SIM. eg. HID mobile and legic
Bluetooth Range	Touch to 100 ft (0 to 30 meters)
Wi-Fi	802.11b/g/n/ac 5.8 GHz, 802.1x
Encryption	Hardware secure element EAL 6+, AES 256, ECC, TLS, x.509
Interoperability	Natively interoperable with Safetrust sensor ecosystem (built on Bluetooth 5.0 mesh)
Accessories	Accessories are optional. Work with your Safetrust representative.
Warranty	Limited Lifetime

Safetrust, IoT Sensor USB, Credential Manager and Safetrust Wallet are all trademarks of Safetrust Inc. All other product and company names are trademarks of their respective holders; use of these trademarks does not imply any affiliation with or endorsement by their holders. All claims of compatibility are made by Safetrust only. *HID®, iCLASS SE®, Seos®, multiCLASS SE®, and Indala® are trademarks of HID Global Corporation/ASSA ABLOY AB. LEGIC® and its associated products are trademarks of LEGIC Identystems Ltd. Neither of these companies nor its affiliates have manufactured or endorsed this product and have no association to Safetrust Inc.

